

FOR LEASE

61 & 67 Bonaventura Drive
SAN JOSE, CALIFORNIA

TWO 1,320 SF FLEX INDUSTRIAL
CONDOS AVAILABLE FOR LEASE



EXCLUSIVELY
LISTED BY

RALPH BORELLI

Chairman

P: 408-521-7117

E: ralph@ralphborelli.com

DRE # 00465691

JON D'AMICO

Property Mgmt./Brokerage

P: 408-521-7107

E: jon@borelli.com

DRE # 01838839



SITE PLAN

 Available Units

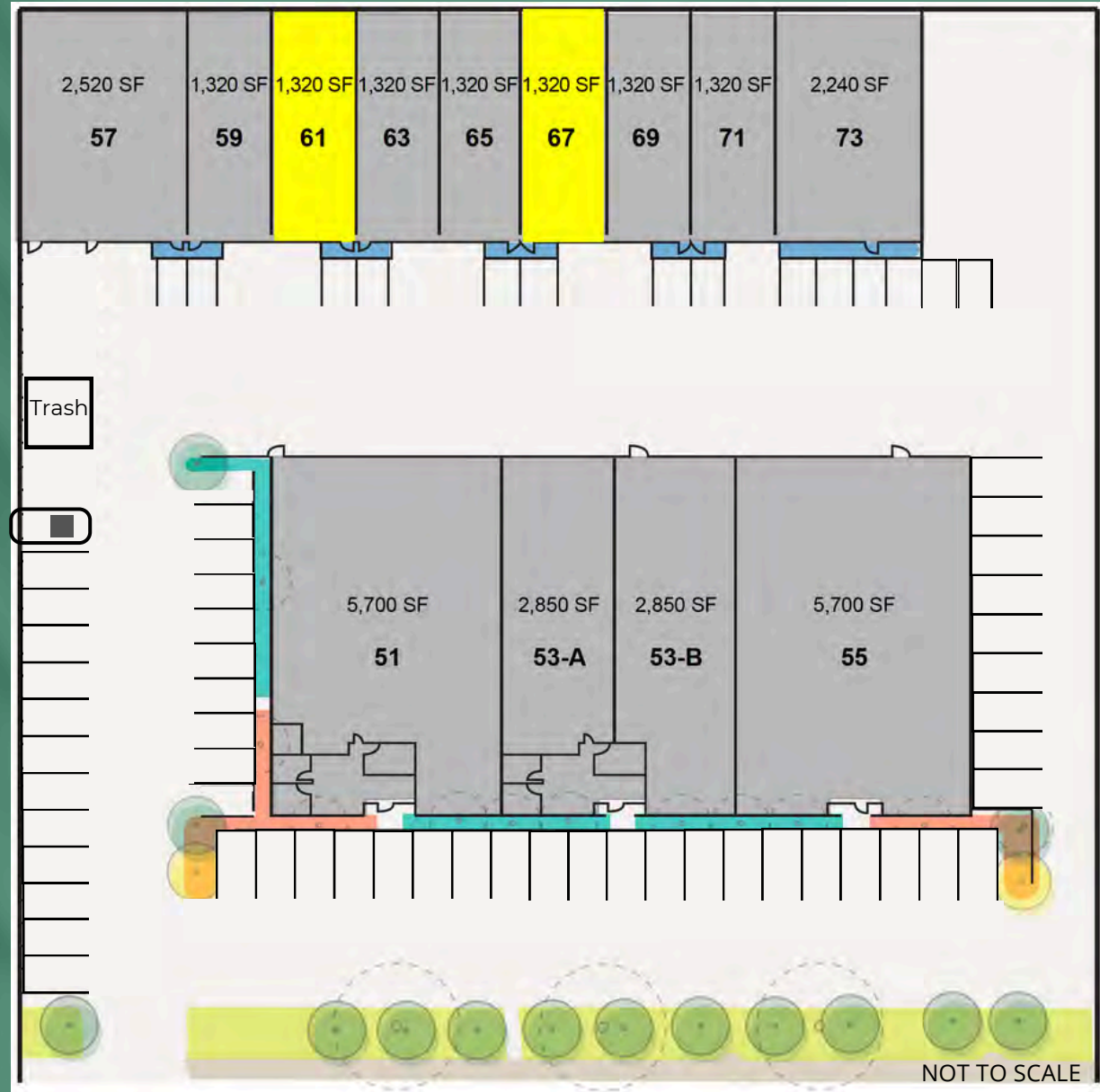

SUMMARY - 61 BONAVENTURA DR.

ADDRESS

61 BONAVENTURA DRIVE, SAN JOSE, CA 95134

BLDG SF

1,320 SF

LEASE RATE

\$1.79/SF/MO. IG + \$0.25/SF/MO. CAM

TERM

3-5 YEARS PREFERABLE

OCCUPANCY

AVAILABLE OCTOBER 2024

FEATURES

- GRADE LEVEL ROLL-UP DOOR
- RECEPTION AREA, PRIVATE OFFICE, RESTROOM AND WAREHOUSE
- APPROX. 25% OFFICE/DROP CEILING, 75% WAREHOUSE
- 100 AMPS
- FIRE SPRINKLERED
- WALKING DISTANCE TO THE VTA BONAVENTURA LIGHT RAIL STATION
- LOCAL OWNERSHIP AND MANAGEMENT

FLOOR PLAN

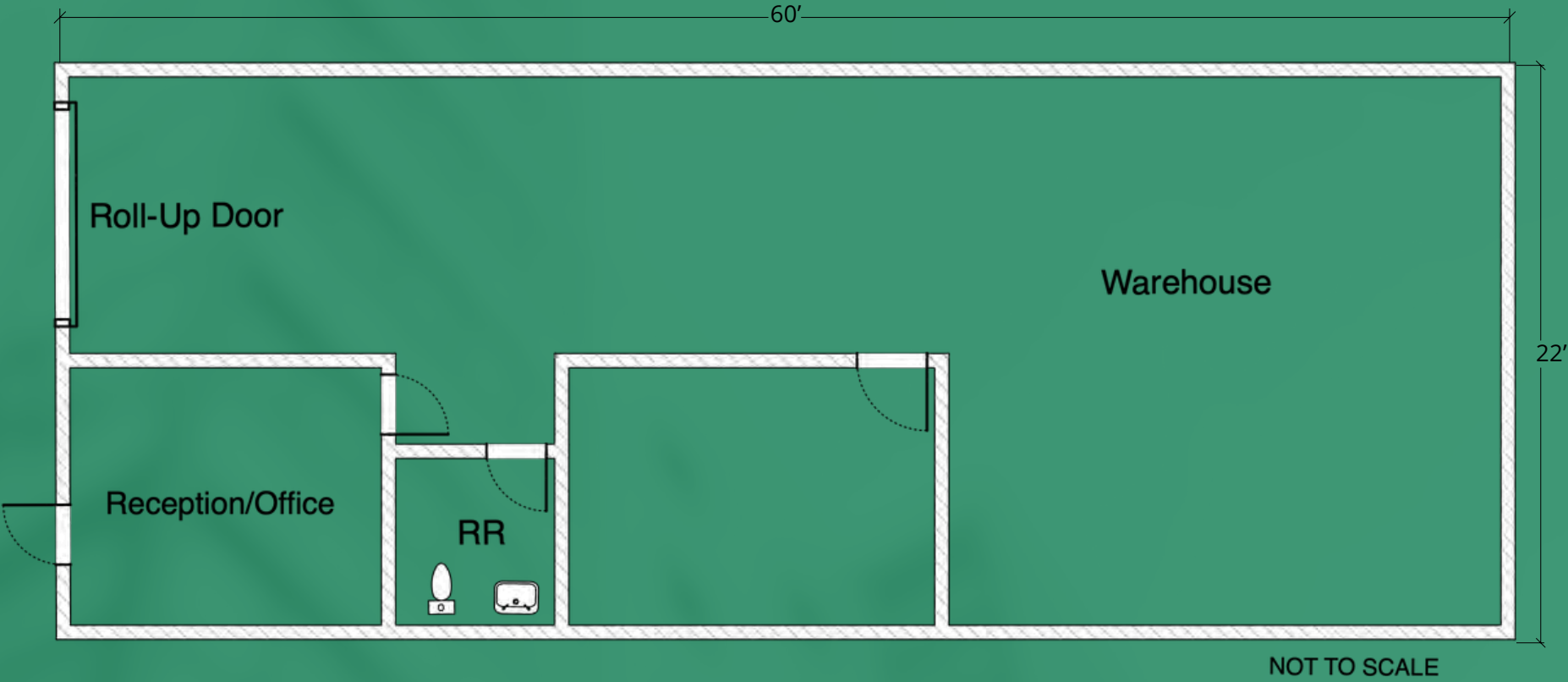

SUMMARY - 67 BONAVENTURA DR.

ADDRESS	67 BONAVENTURA DRIVE, SAN JOSE, CA 95134
BLDG SF	1,320 SF
LEASE RATE	\$1.85/SF/MO. IG + \$0.25/SF/MO. CAM
TERM	3-5 YEARS PREFERABLE
OCCUPANCY	AVAILABLE OCTOBER 2024
FEATURES	<ul style="list-style-type: none">• GRADE LEVEL ROLL-UP DOOR• RECEPTION/OFFICE AREA, RESTROOM, SMALL MEZZANINE AND WAREHOUSE• APPROX. 10% OFFICE/DROP CEILING, 90% WAREHOUSE• 100 AMPS• FIRE SPRINKLERED• WALKING DISTANCE TO THE VTA BONAVENTURA LIGHT RAIL STATION• LOCAL OWNERSHIP AND MANAGEMENT

FLOOR PLAN

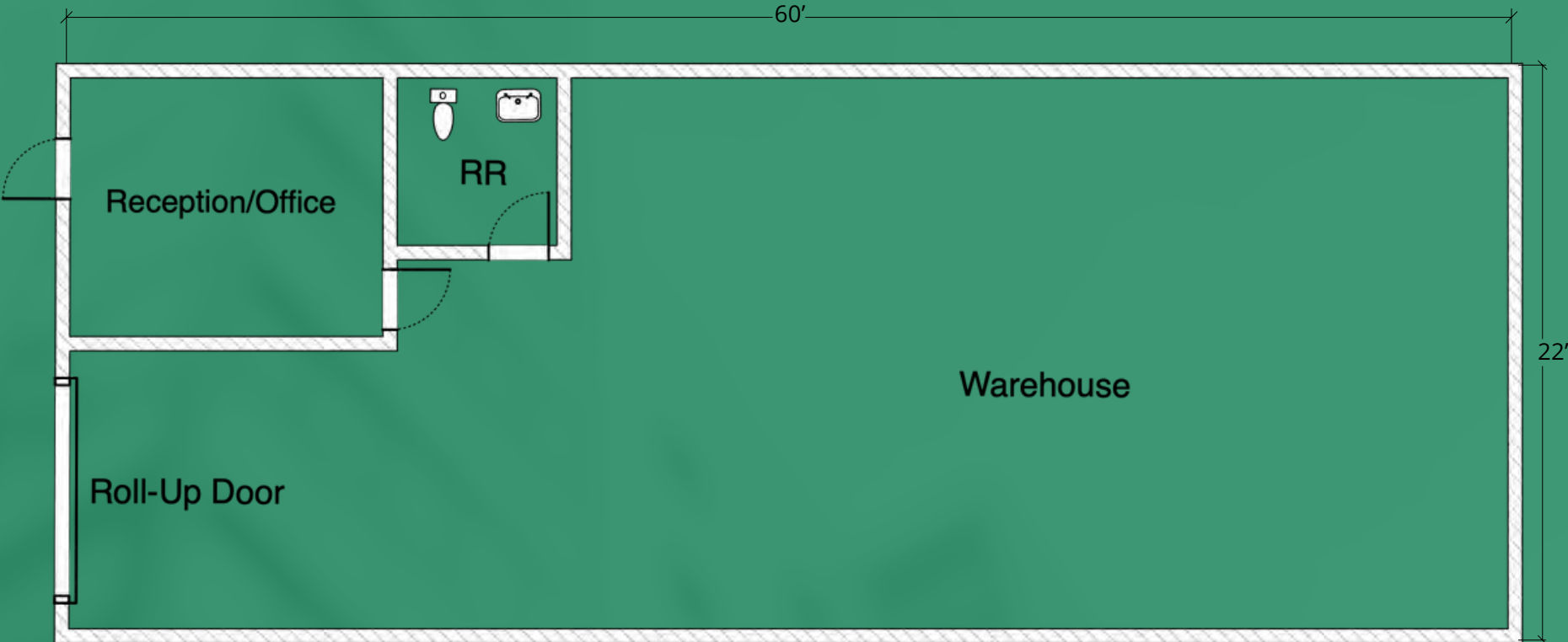

NOT TO SCALE

LOCAL AMENITIES

- Jersey Mike's Subs
- Safeway
- Baja Fresh
- Premier Pizza
- The Kabab Shop
- Chipotle Mexican Grill
- Red Robin
- Peet's Coffee
- Poke House
- Dave's Hot Chicken
- Cold Stone

- Flower Flour
- Okayama Express Sushi
- Subway
- Starbucks
- Pho Viet
- Thai Orchid
- Dish n Dash
- Una Mas!

61 & 67 BONAVENTURA DR.



VTA: Bonaventura Station

VTA: Component Station

VTA: Karina Station

VTA: Metro/Airport Station



LOCATION



SAN FRANCISCO

OAKLAND

OAKLAND INTERNATIONAL AIRPORT

SAN FRANCISCO INTERNATIONAL AIRPORT

PALO ALTO

SAN JOSE MINETA INTERNATIONAL AIRPORT

63 BONAVENTURA DR

SAN JOSE

— Est. 1955 —

BORELLI

INVESTMENT COMPANY

2051 Junction Ave., STE 100, San Jose, CA 95131
P: 408-453-4700 | borelli.com

EXCLUSIVELY
LISTED BY

RALPH BORELLI

Chairman

P: 408-521-7117

E: ralph@ralphborelli.com

DRE # 00465691

JON D'AMICO

Property Mgmt./Brokerage

P: 408-521-7107

E: jon@borelli.com

DRE # 01838839